

REV.	DESCRIPTION	DATE
A	RELEASE	JUN 03, 2016

SPECIFICATION

MATERIAL:

Insulator: High Temperature Thermoplastic, UL 94V-0.

Contact: Copper Alloy

PLATING:

Contact: Plated 50u'' Ni Overall.

Plated Au Selective Contact Area.

Plated 100u'' Sn Over Ni On Solder Area.

Shell: Plated 50u'' Ni Overall,

Plated 1u''Au Selective Contact Area.

Electrical:

Current Rating: 0.5mA AC/DC max.

Voltage Rating: 125V AC/DC.

Ambient Temperature Range: -20° C~+60° C.

Storage Temperature Range: -40° C~+70° C.

Ambient Humidity Range: 95% R.H. Max.

Contact Resistance: 100m max.

Insulation Resistance: 1000M min./500VDC

Mating Cycles: 10,000 Insertions

产品耐温温度: 260° C \pm C S(1.70)° C S(1.70)+5° C

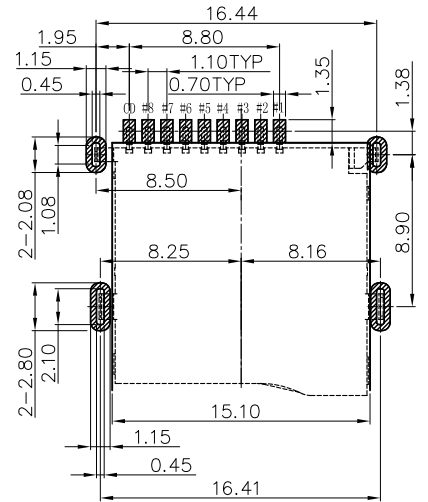
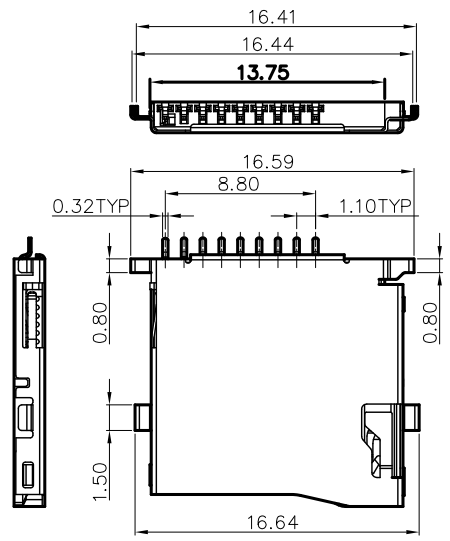

RECOMMEND PCB LAYOUT
TOLERANCE: ± 0.05
TOP VIEW

- PCB AREA
- CONNECT AREA
- KEEP OUT AREA

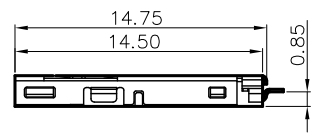
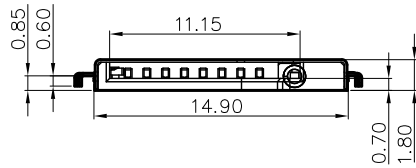

PART NUMBER INFORMATION :

5101108-X1124S-X

- SERIES CODE
- SMT 90°
- T-CARD
- SINGLE TYPE
- NUMBER OF POSITIONS
- R: RoHS
- H: HALOGEN FREE
- FOLLOW NUMBER
- WITH PUSH
- INSERT TYPE
- PLATING SEE TABLE

PIN NO	PIN ASSIGNMENT	PIN NO	PIN ASSIGNMENT
1#	DAT2 信号	6#	VSS 接地
2#	CD/DAT3 信号	7#	DATO 信号
3#	CMD 数据输入	8#	DATI 信号
4#	VDD 电压/电源	CD	CD 侦测端
5#	CLK 时钟		

DESCRIPTION OF PLATING ON TERMINALS

NO.	EXPLAIN	NO.	EXPLAIN
0	GOLD FLASH	3	GOLD 15u''
1	GOLD 5u''	4	GOLD 20u''
2	GOLD 10u''	6	GOLD 30u''

TOLERANCE .0= ± 0.25 .00= ± 0.15 .000= ± 0.05 ANG.= $\pm 3^\circ$	DRAWER 2/1 CHECK 2/1 APP'D 2/1 PRODUCT SPEC. —	INMO 东莞市英墨电子有限公司 INMO Electronics Co.,Ltd NAME T-FLASH 8+1P PUSH 1.80H. (沉板0.85全插)	
			UNITS : mm
SCALE NONE	SIZE A7	SHEET 1 OF 1	REV. A

